

Expositor  
item 02

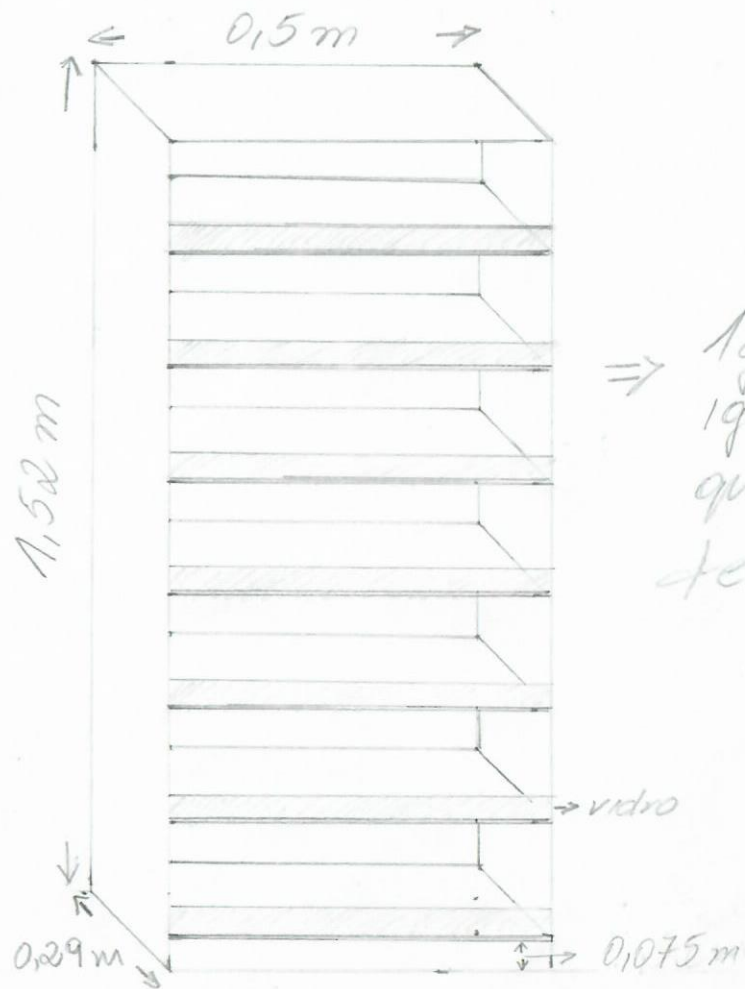

⇒ 1 gôndola  
igual às  
que já  
temos

*[Signature]*

Armário de Controlados  
item 01

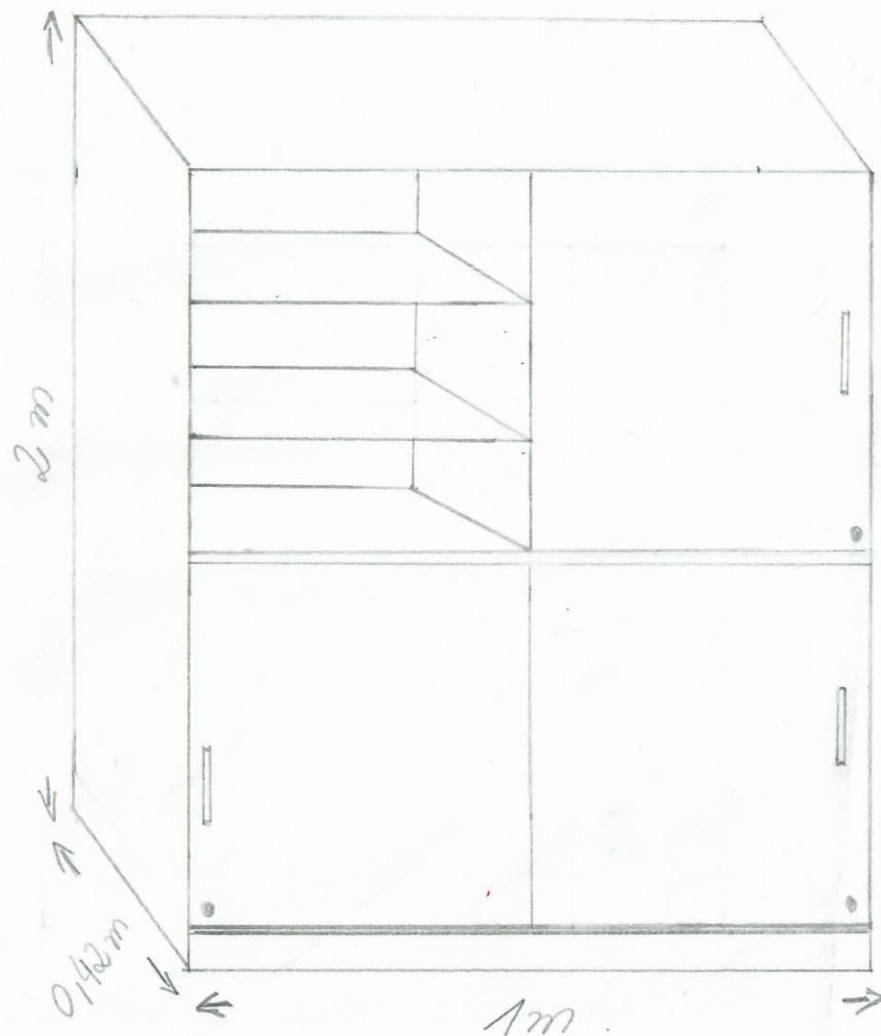

\* 2 prateleiras em cada parte  
gerando 3 "vãos"  
\* Portas de "control" c/ chave

# Farmacia - Balcão p/ insumos

item 03

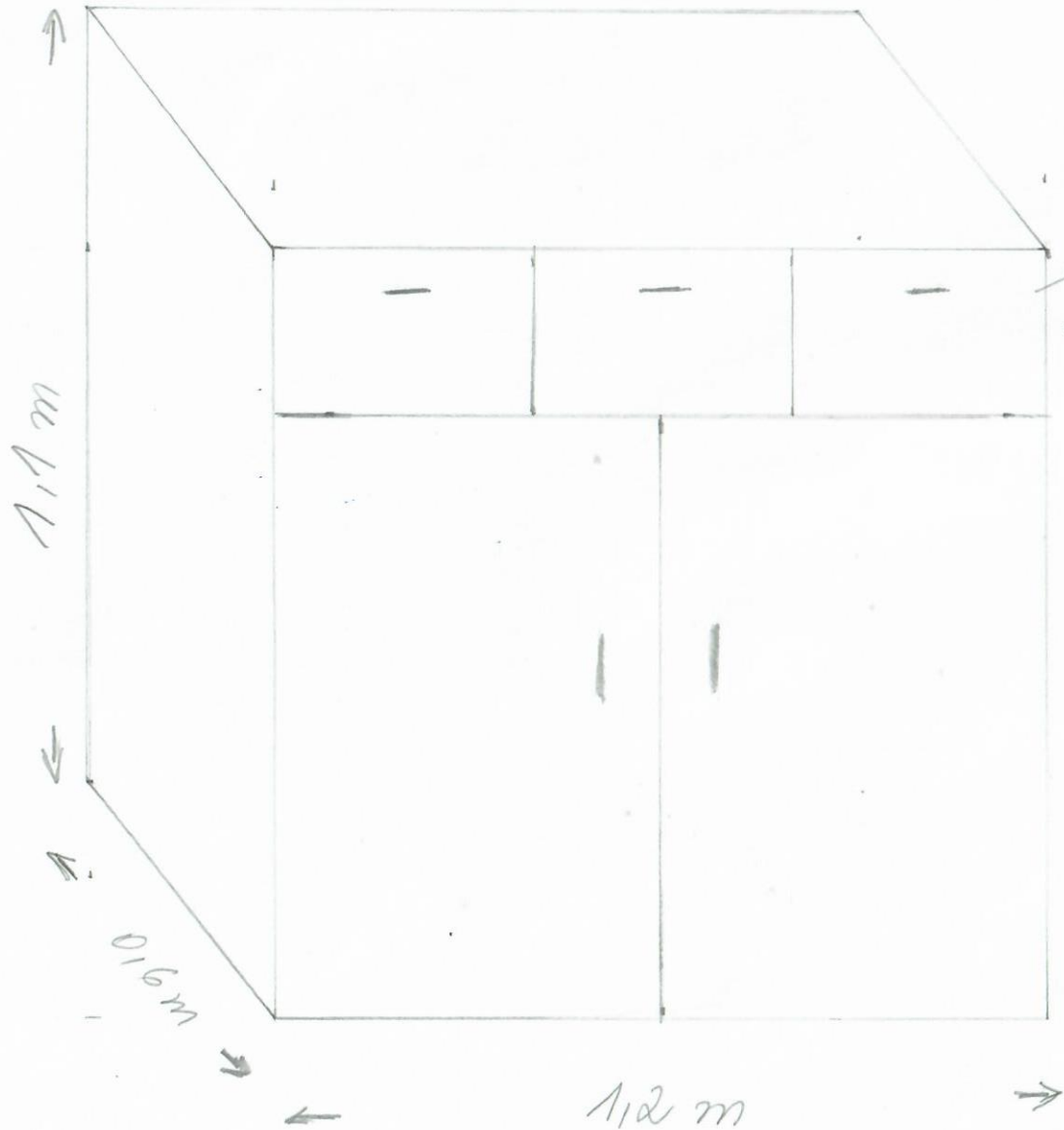

→ Ver medidas das gavetas do consórcio

→ Três gavetas fundas iguais as do consórcio p/ guardar documentos

→ Duas portas c/ prateleiras

*[Handwritten signature]*

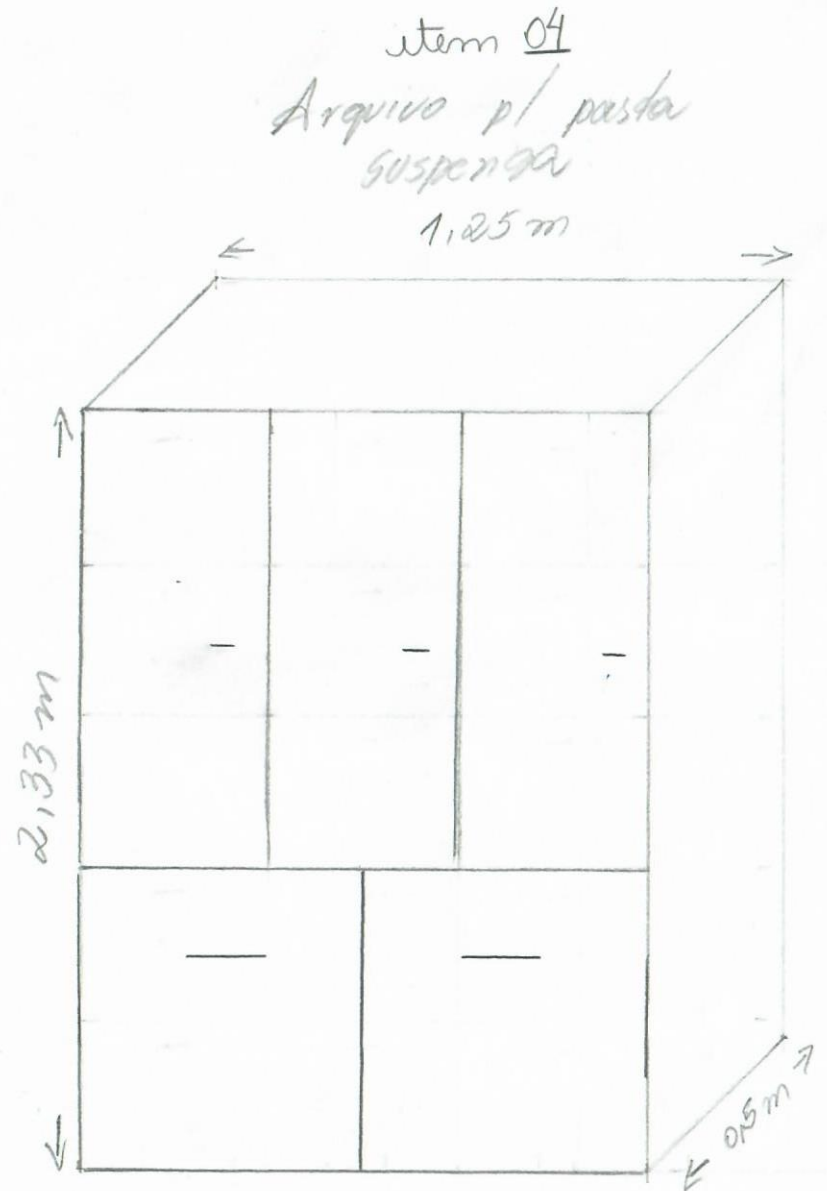
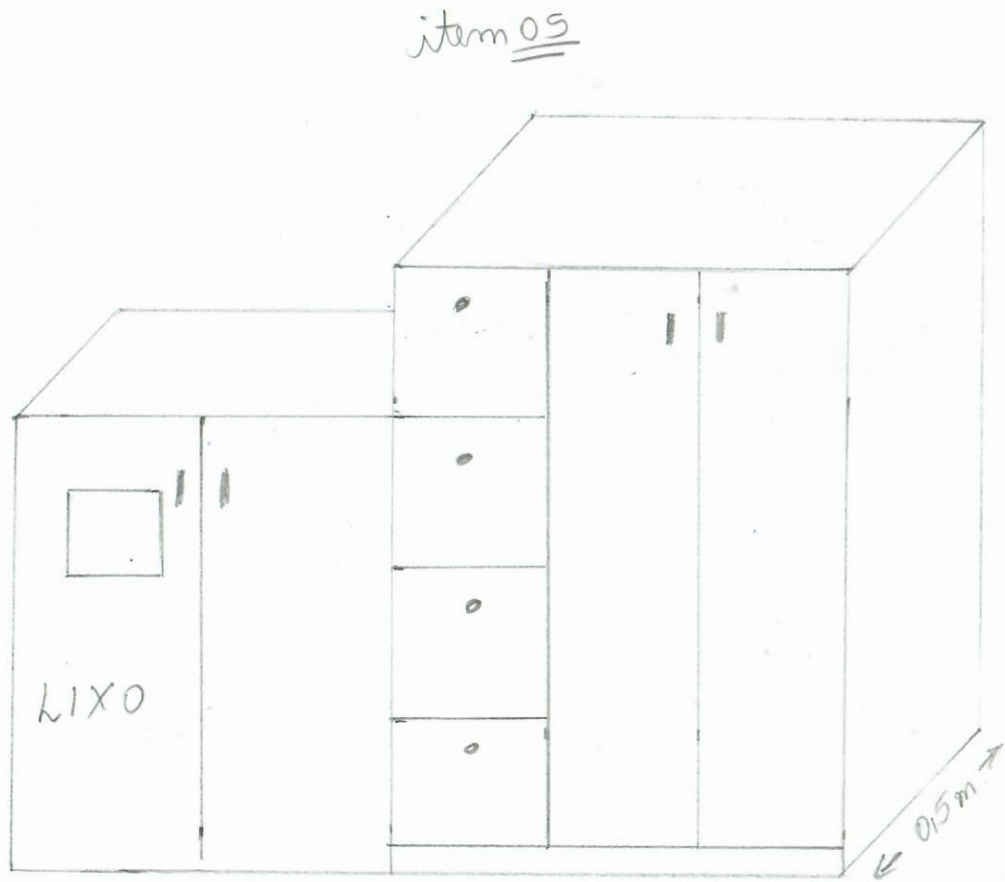

*Carimato*

item 06

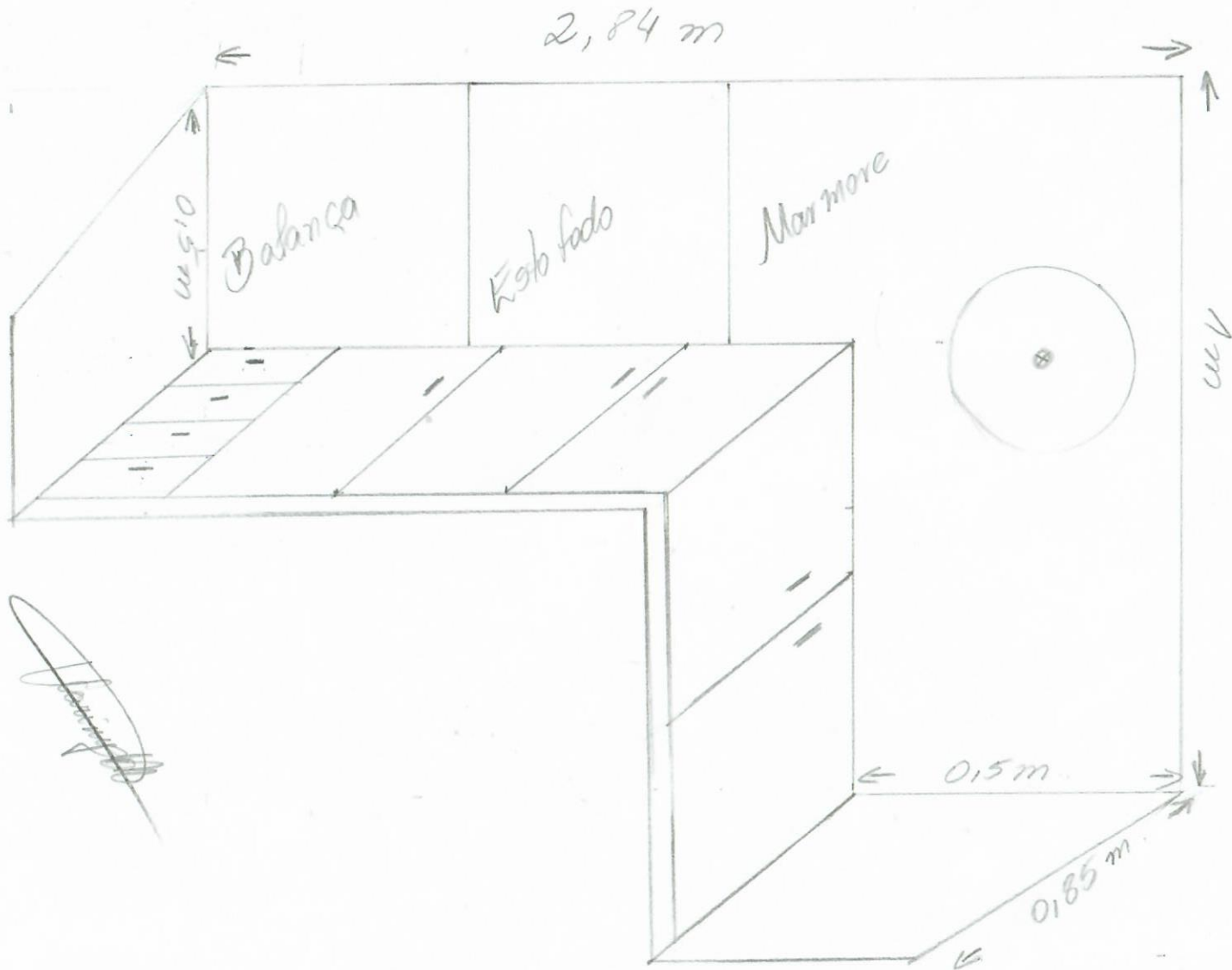

S. SIVAN

Móvel Farmácia  
Depósito - item 07

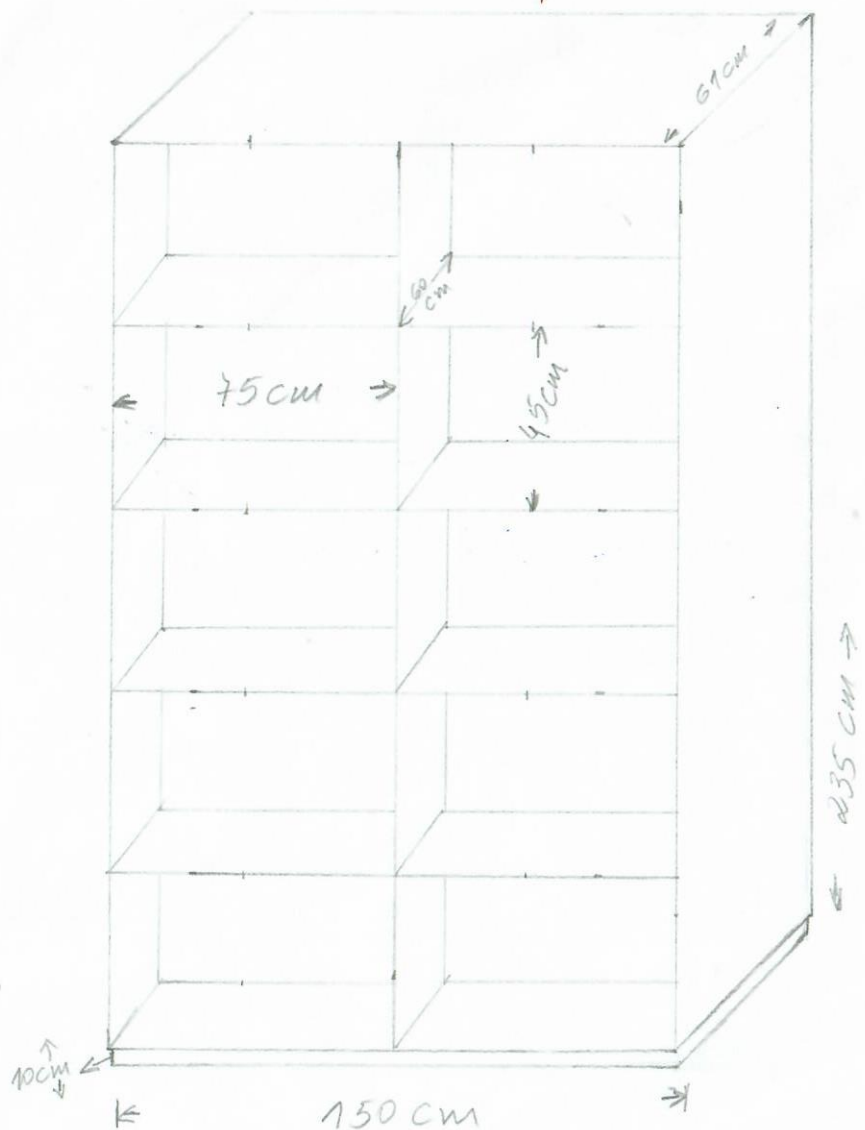

item 08

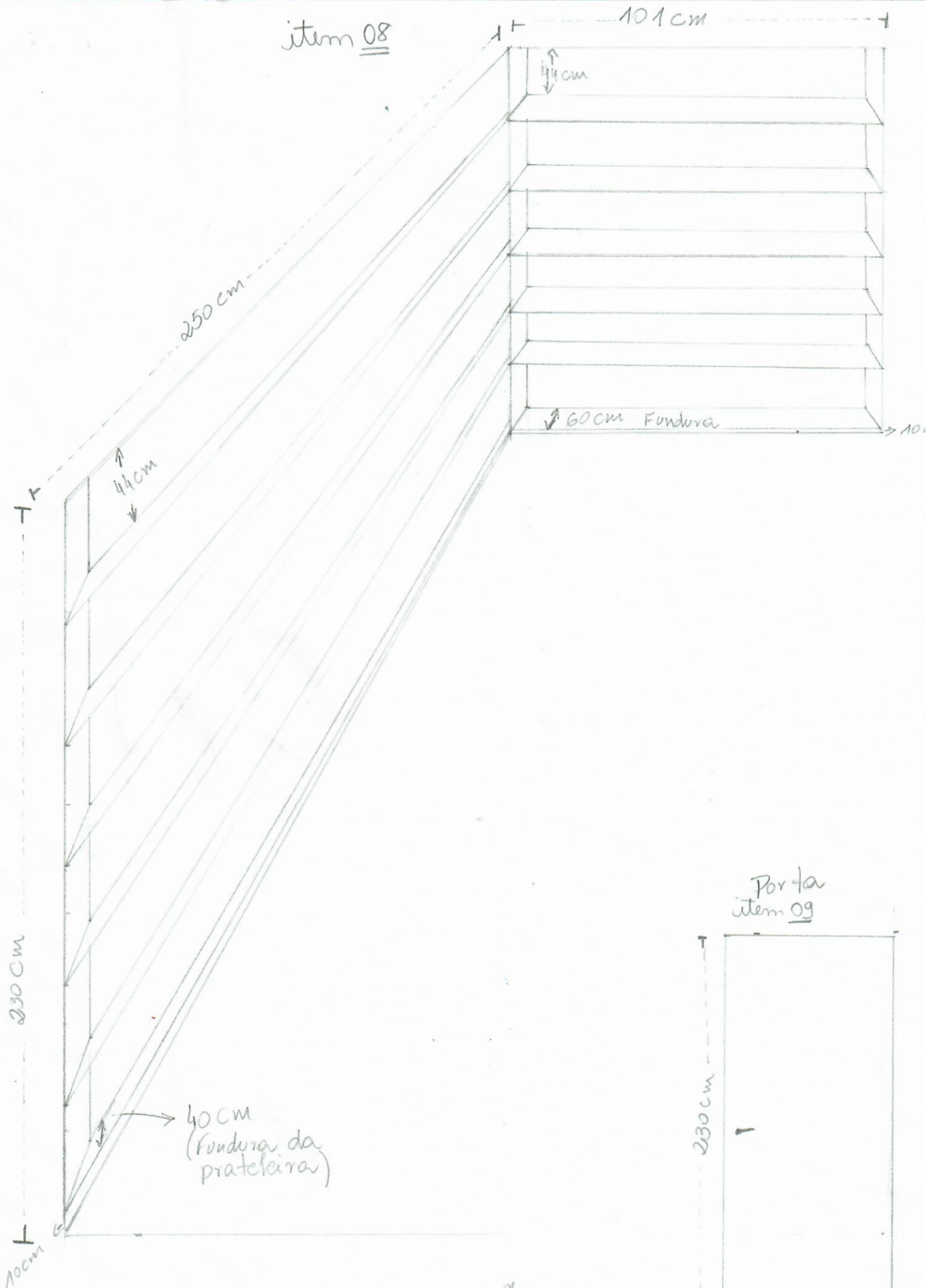

Porta  
item 09

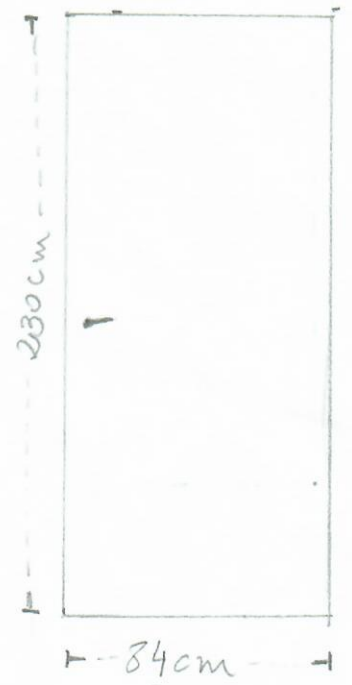

*[Handwritten signature]*