

PLANTA BAIXA
Escala 1/50

PERGOLADO DOS BANCOS

Área Total: 24,96m²

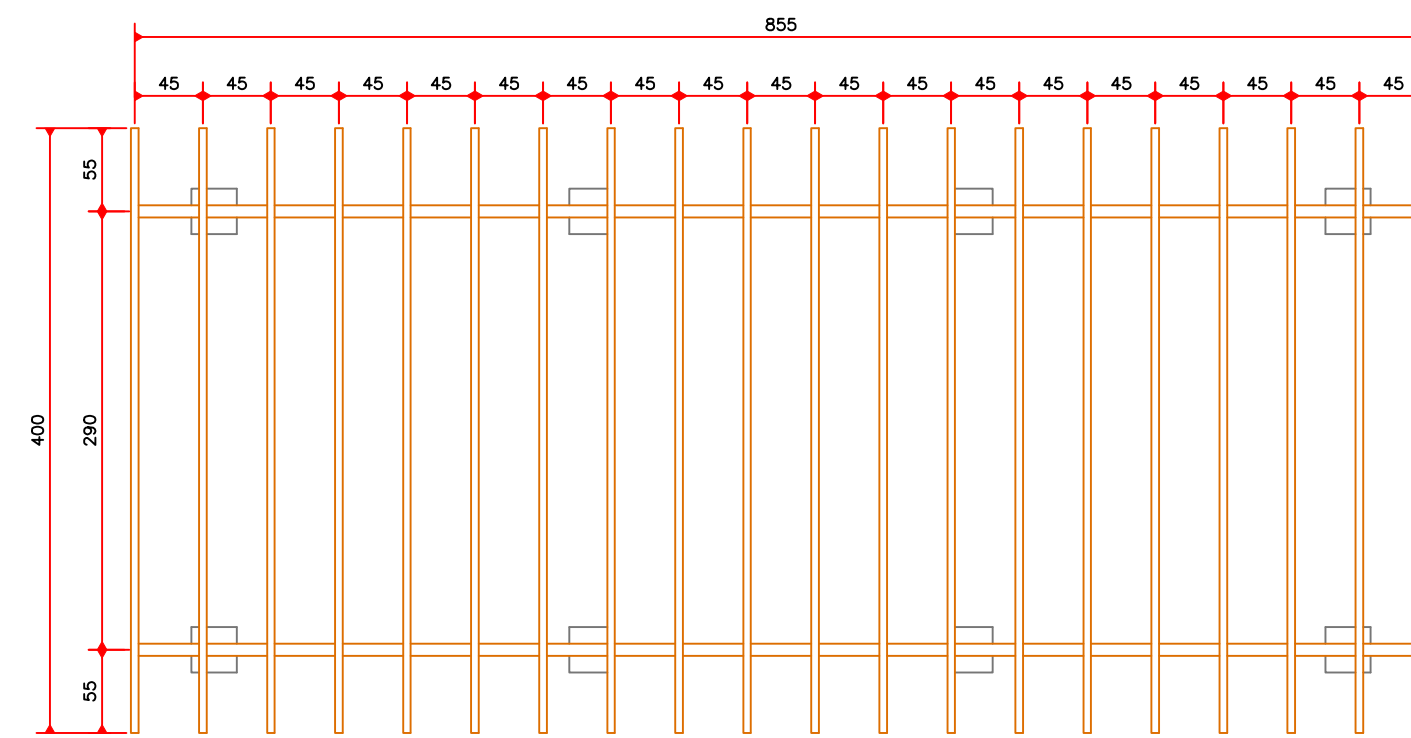

VISTA SUPERIOR
Escala 1/50

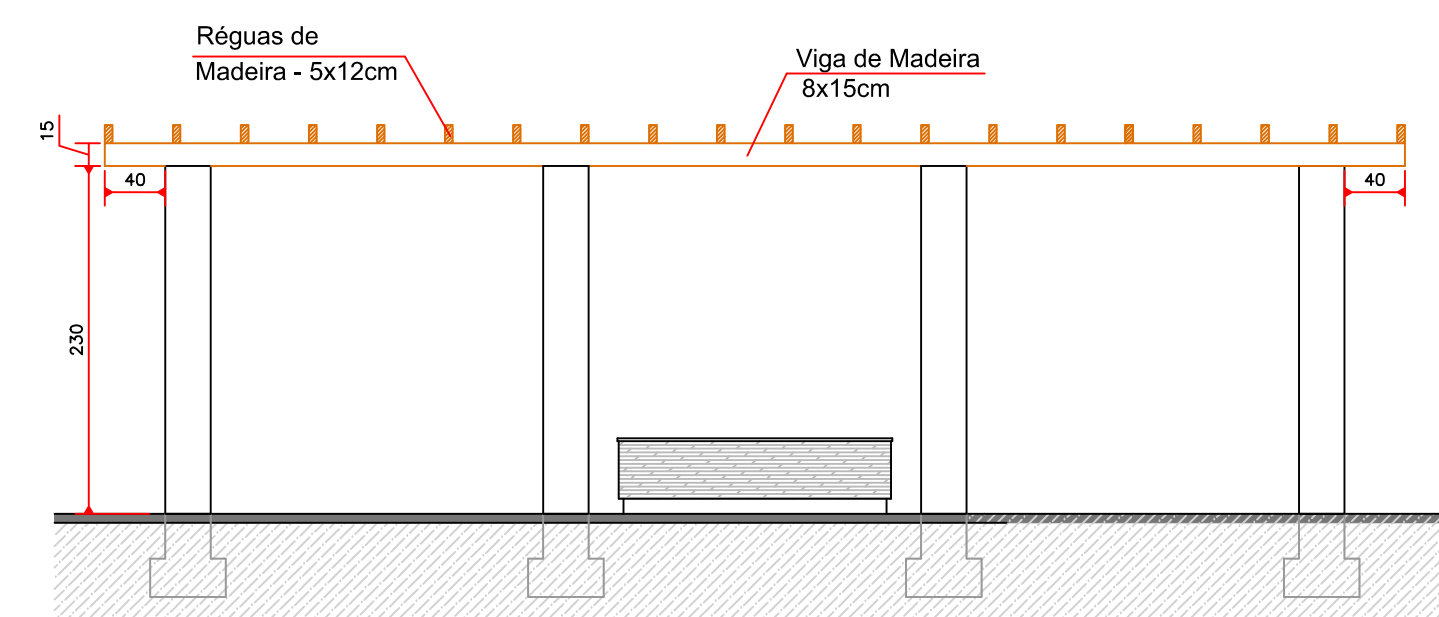

Corte BB'
Escala 1/50

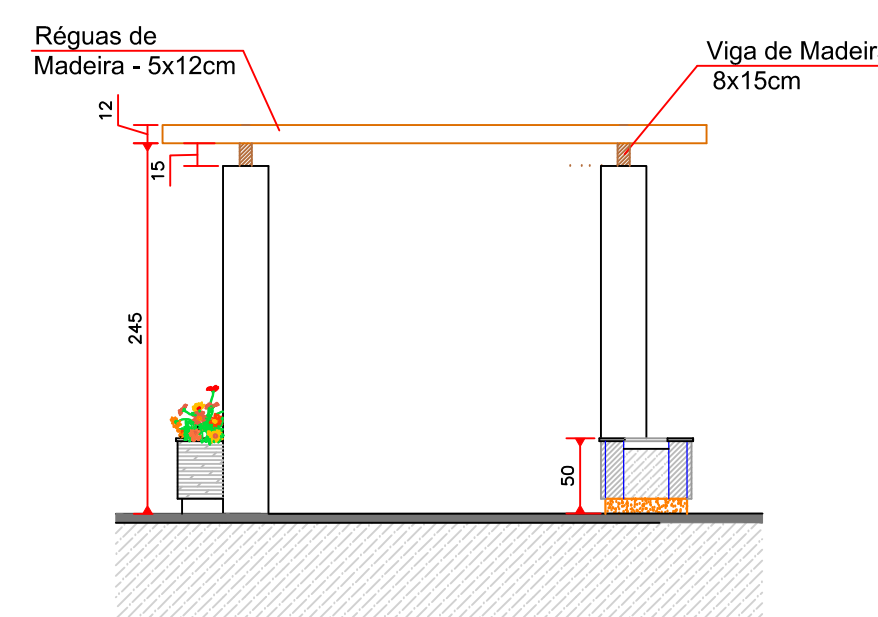

Corte AA'
Escala 1/50

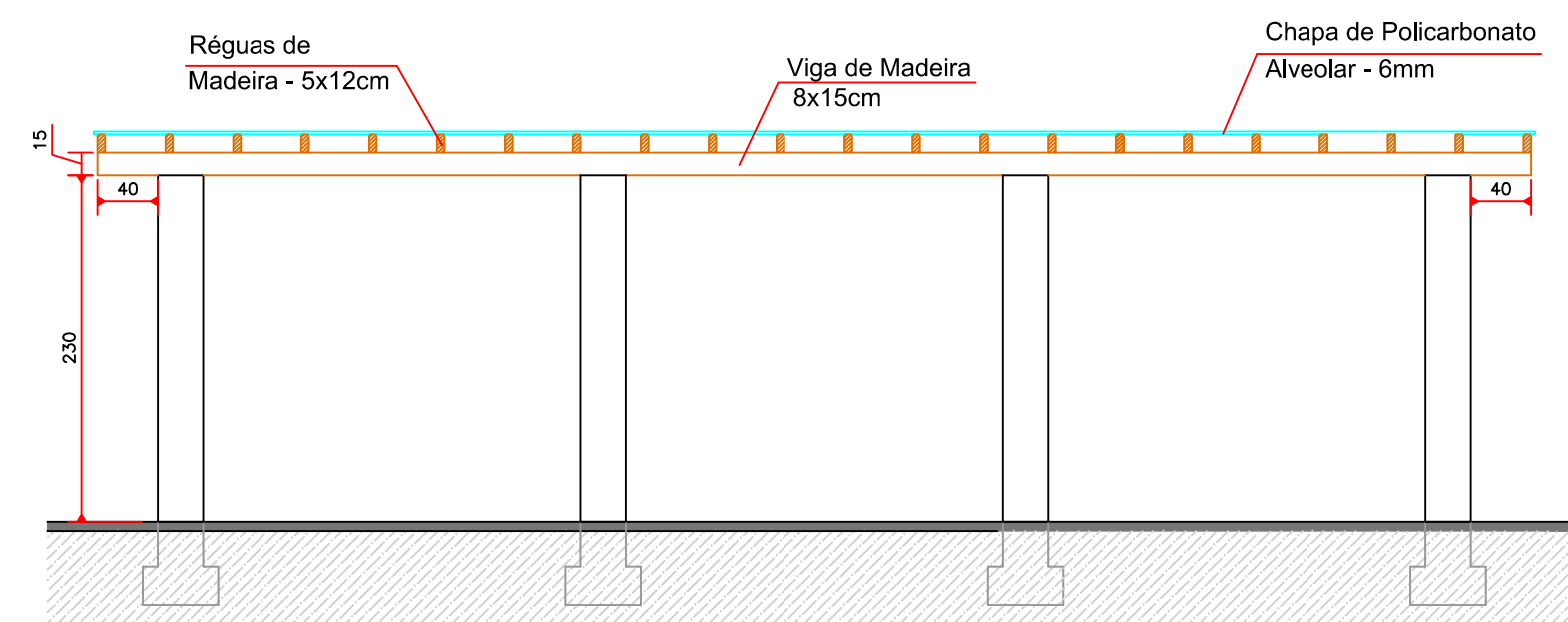

Corte BB'
Escala 1/50

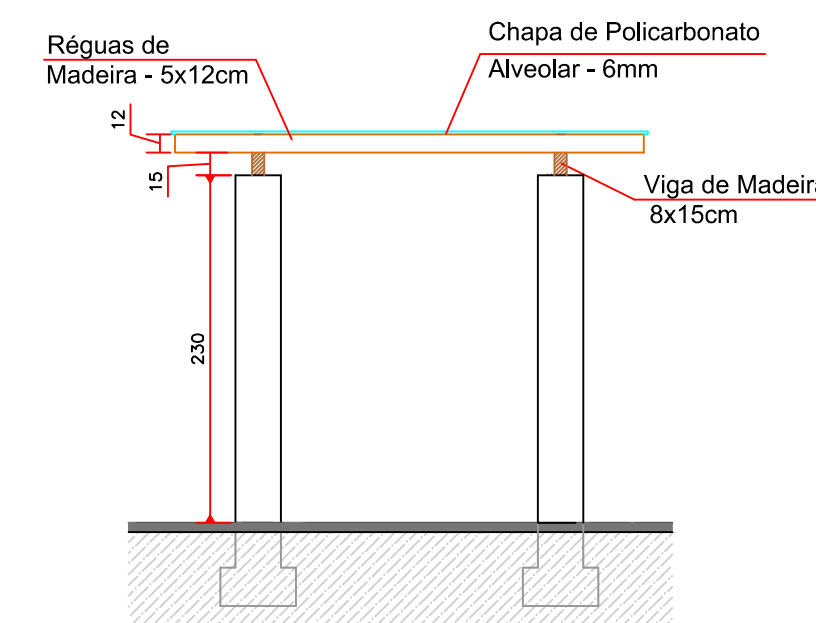

Corte AA'
Escala 1/50

PERGOLADO DAS MESAS DE JOGOS

Área Total: 20,01m²

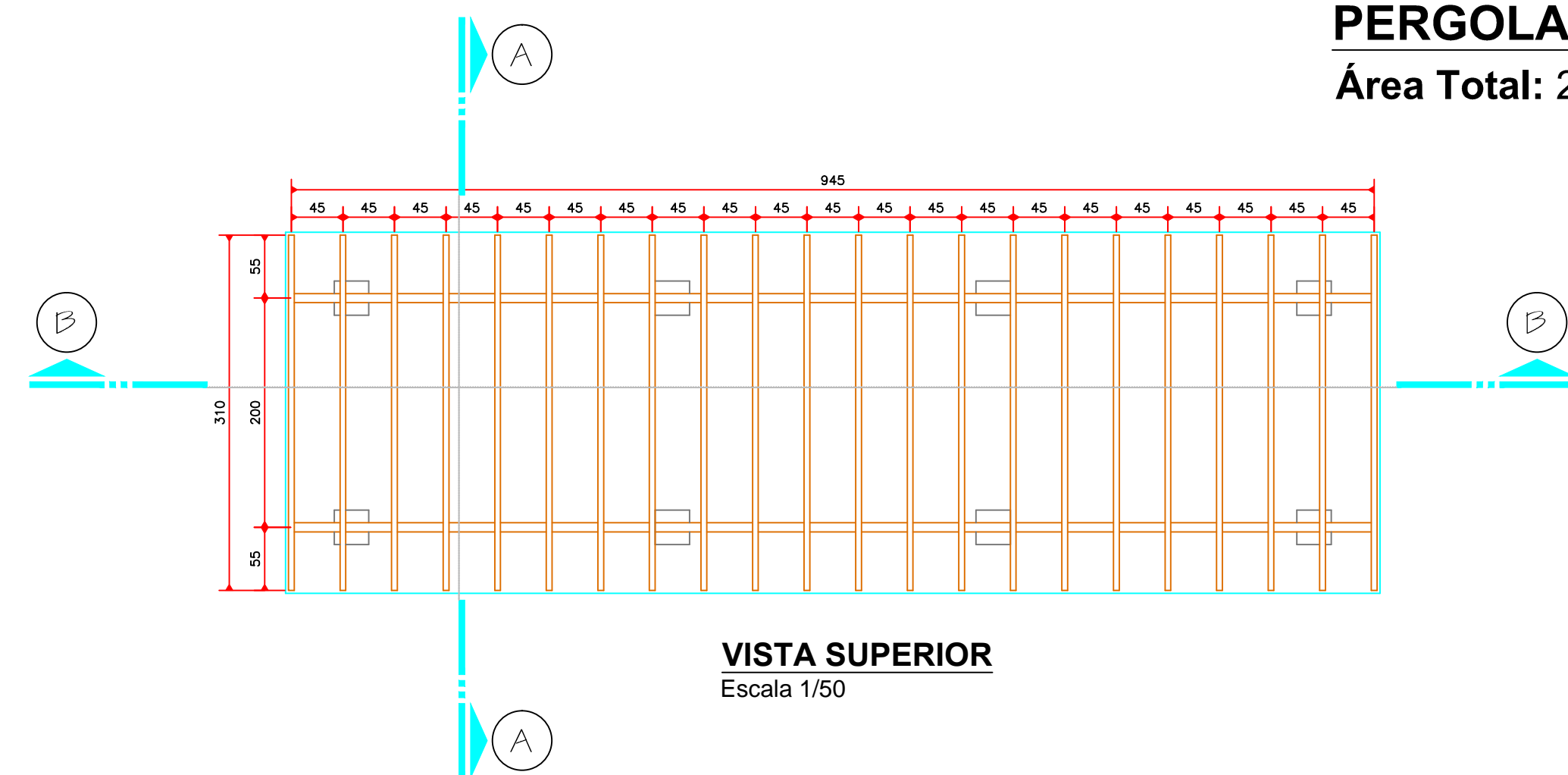

VISTA SUPERIOR
Escala 1/50

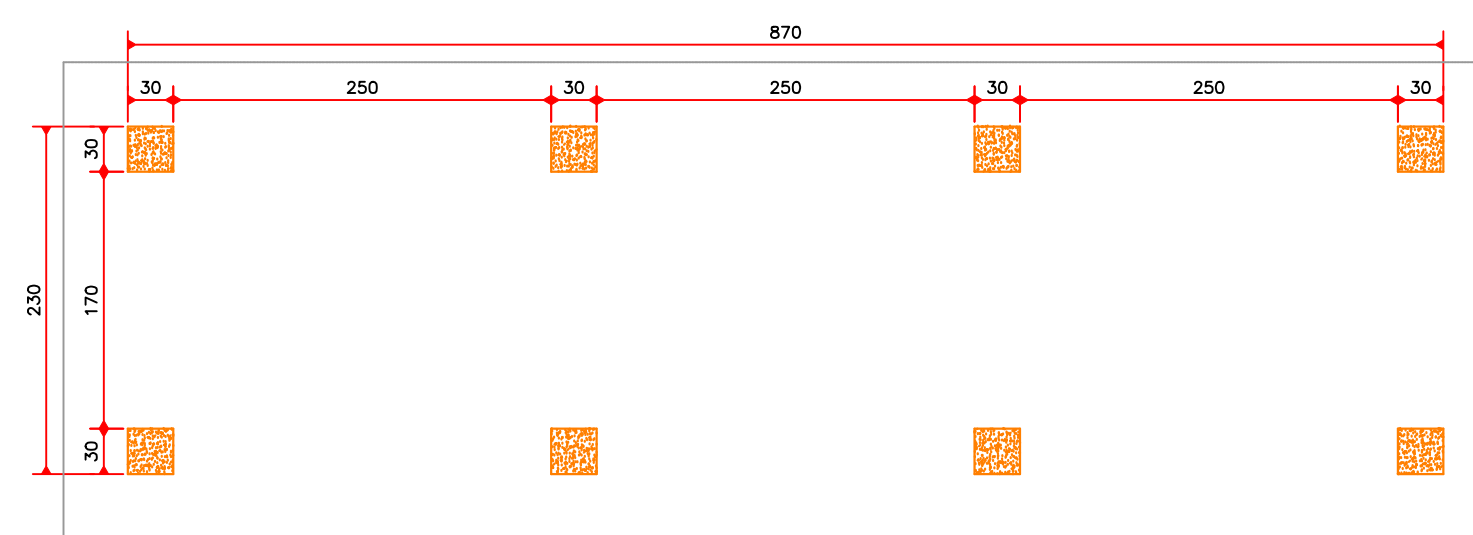

PLANTA BAIXA
Escala 1/50

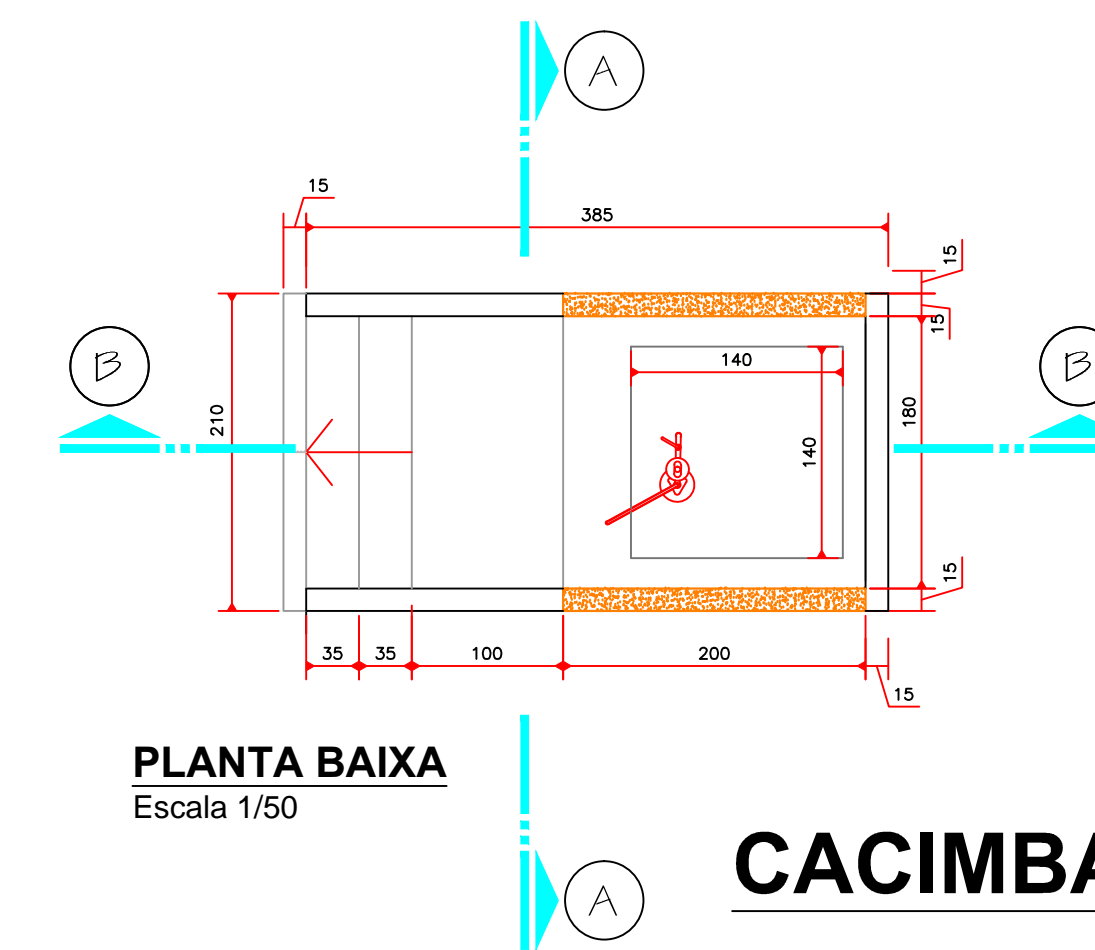

PLANTA BAIXA
Escala 1/50

CACIMBA

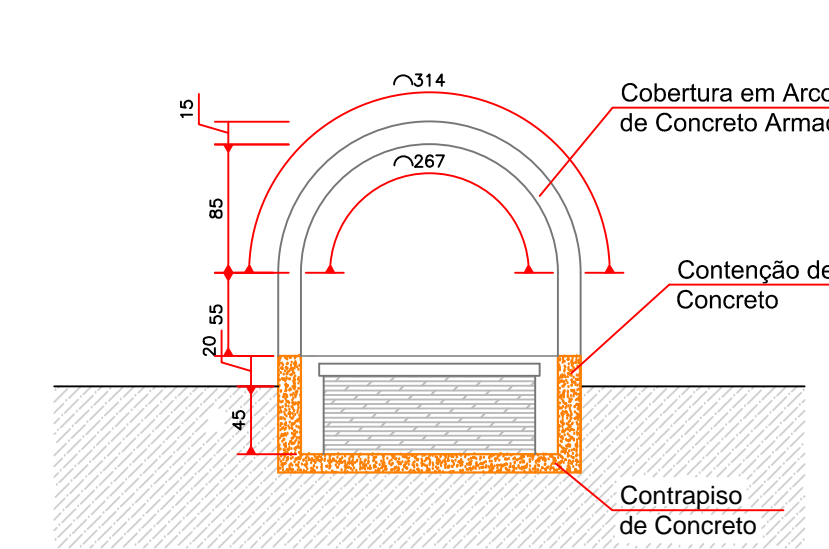

Corte AA'
Escala 1/50

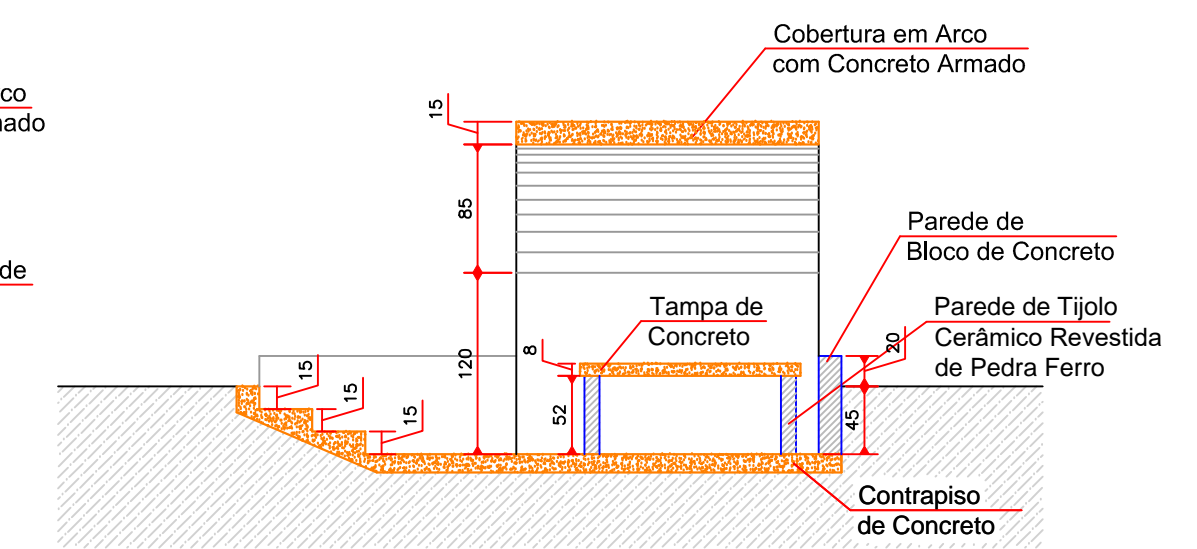

Corte BB'
Escala 1/50

AMURES		ASSOCIAÇÃO DE MUNICÍPIOS DA REGIÃO SERRANA	
PREFEITURA MUNICIPAL DE CAMPO BELO DO SUL - SC		08/09	
ASSESSORIA TÉCNICA		OBRA	
PREFEITA: CLAUDIANE VARELA PUCCI		PRAÇA DA CACIMBA	
PROJETO: Elisiane Grudtner CAU - A17356-8		PROJETO ARQUITETÔNICO PERGOLADOS E CACIMBA	
		PLANTA BAIXA, CORTES, ELEVACÕES E VISTA SUPERIOR	
		ÁREA TOTAL DA INTERVENÇÃO: 1.241,00m²	
		RRT: 6505695.	
		Localização: Rua Anísio Martins de Moraes, Rua José da Costa Varela, Rua Major Teodoro Furtado - Centro, Campo Belo do Sul SC.	
DESENHO: Christine Bernardo Waltrick	TOPOGRAFIA:	Escala: Indicada	DATA: 11/ 2021